

big ideas

10 boundary-pushing projects that are revolutionizing the way we think about design, climate, culture, and society

- hot heart** 154
- the red sea project** 155
- populous** 156
- fx mayr wellness eco retreat** 157
- musée du fleuve** 158
- river ring** 159
- moliving** 160
- tren maya station** 161
- majara residence** 162
- national museum of korean literature** 163

[See more at **hospitalitydesign.com**](https://www.hospitalitydesign.com)

MAJARA RESIDENCE
p. 162



By ALIA AKKAM, MATT DOUGHERTY, MARIA GALLUCCI, and WILL SPEROS

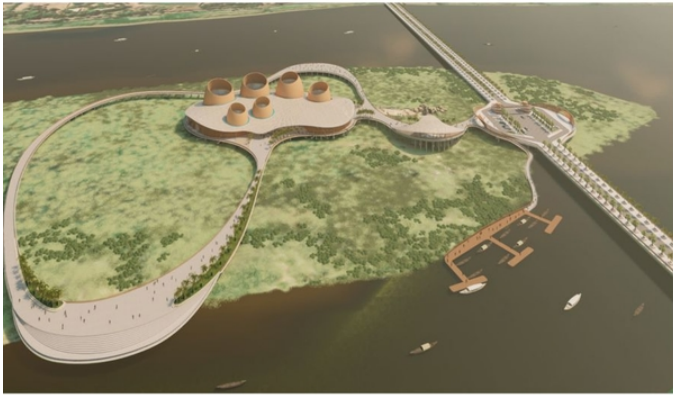

Musée du Fleuve Niamey, Niger

To illuminate Niger's little-known archaeological and ecological riches, design firm Stantec is joining University of Chicago paleontology professor and National Geographic explorer-in-residence Paul Sereno (as well as a team of local and international educators, scientists, researchers, and anthropologists) to develop the Musée du Fleuve in the West African nation's capital of Niamey.

Located on the Niger River, amid pre-Cambrian rock outcroppings, the museum will be an expression of its surroundings. Ténéré, the region now recognized as the south-central Sahara, was once the green and fertile home of dinosaurs. "This is an indelible part of the cultural identity of Niger," says Rebel Roberts, Stantec's vice president and design discipline lead based in the Chicago office. "The architectural story starts there." The pavilions, for example—compressive masonry Trombe structures that provide shelter from intense daytime heat and sandstorms—are inspired by one-time village residences and grain storage units, and are cast and fired by local artisans. Pathways, reminiscent of river trails, are naturally ventilated and protected by tensile structures of fritted glass and photovoltaic cells, "recalling nomadic tents and porches that create public space and a transition from inside out," Roberts adds.

Renderings courtesy of STANTEC